



DYNAMICPRO



Emergency Lighting Solutions

Product Catalogue V1.2



LEADING INNOVATION IN LIFE SAFETY

DynamicPro is a Canadian company specializing in providing integrated technologies in life safety and advanced building management solutions.

Our goals are focussed on enhancing our customer's satisfaction, experience and safety. These are delivered from our headquarters in Canada by our innovative team, in cooperation with VELOX Life Safety. Our state-of-the-art integrated technologies embedded within the proven VELOX CLOUD ecosystem deliver global life safety solutions that are second-to-none.

DynamicPro's expertise is built on more than 15 years of market and product technology expertise to deliver resilient DALI Emergency Light technology with a proven track record of projects worldwide.

The cooperation between the DynamicPro and VELOX in the IoT and CLOUD space delivers unparalleled user friendly integrated solutions using the proven Velox Cloud platform. This delivers a dynamic, integrated & scalable platform for the first time in the life safety industry.

Contents

02 INTRODUCTION

04 DALI NETWORKED SELF CONTAINED
& STAND ALONE EMERGENCY LIGHTING

06 IMPERIA MASTER PANEL

08 DALI NETWORKED LED
EMERGENCY LIGHTS

10 DALI NETWORKED LED EXIT LIGHTS

12 SELF CONTAINED LED
EMERGENCY LIGHTS

14 SELF CONTAINED LED EXIT LIGHTS

16 PARTS LIST

WIRED EMERGENCY LIGHTING DALI NETWORK

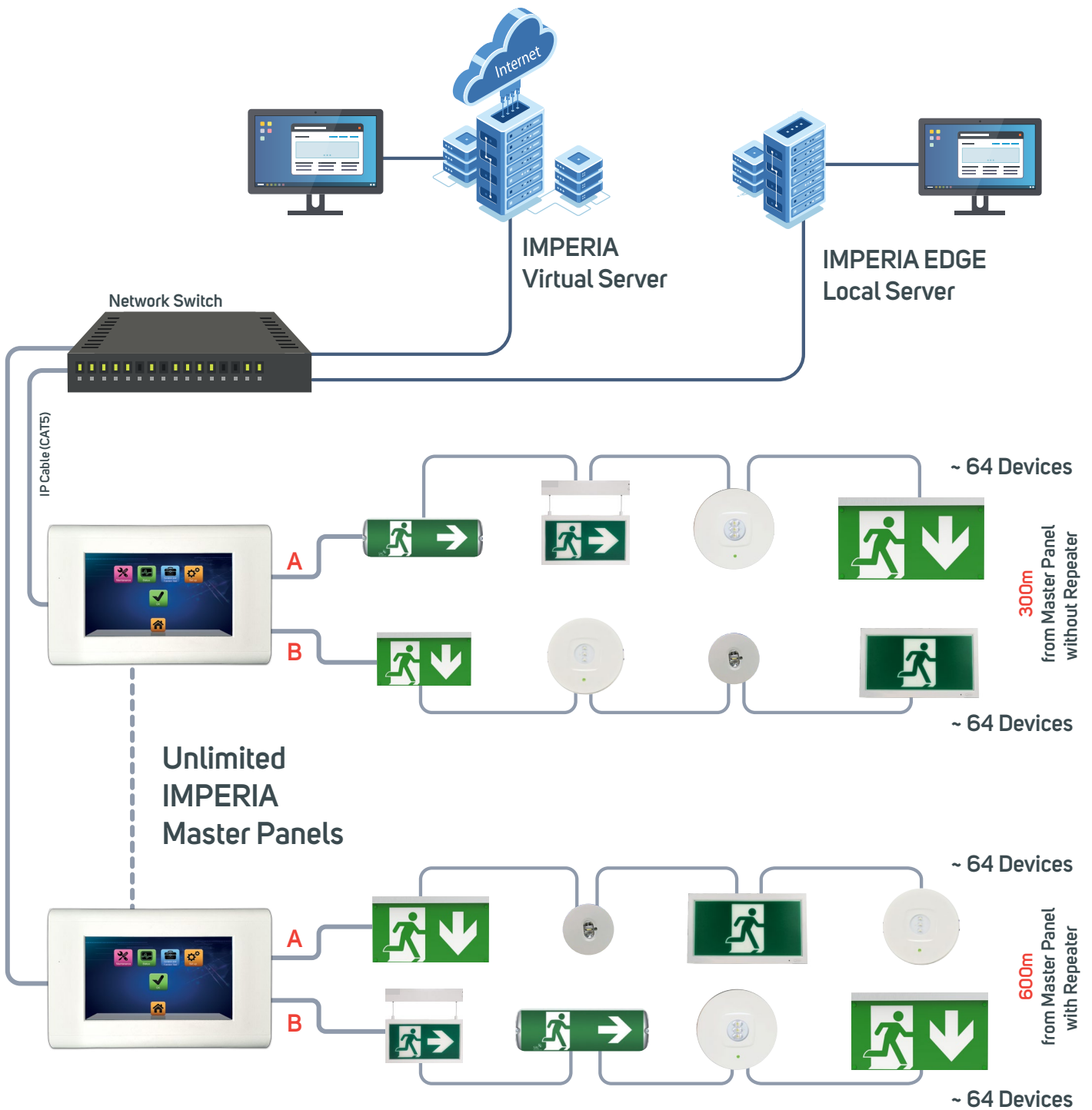

WIRELESS EMERGENCY LIGHTING

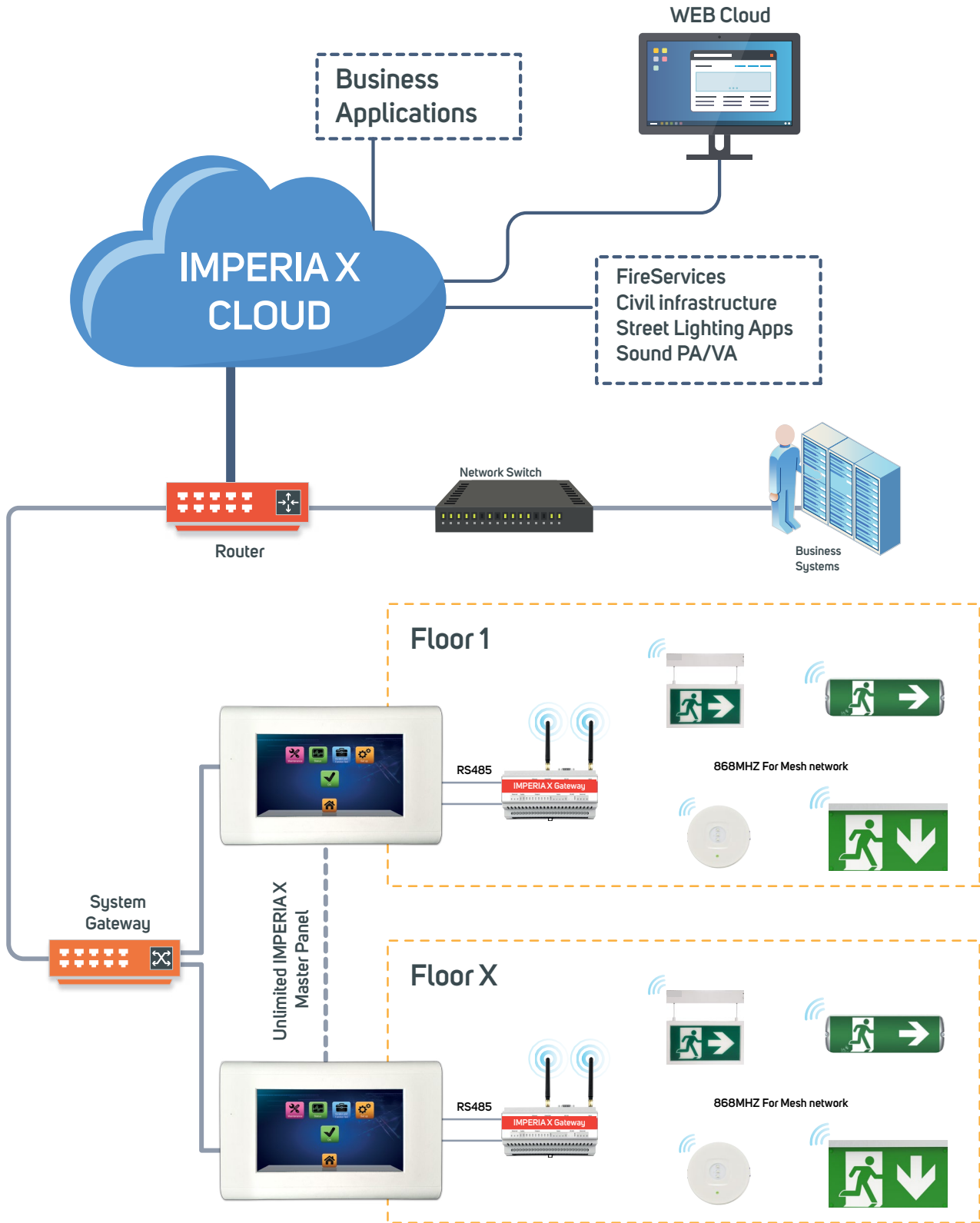

IMPERIA MASTER PANEL

Smart Emergency Master Panel

MODEL : IM-6800



IMPERIA Master Panel is designed and tested to comply with the DALI standards EN 62386 (VO and V1), for DALI emergency lighting components.

FEATURUES

- IMPERIA master panel monitors all fittings connected to it using the DALI protocol, and monitors the following parameters of each light fitting as well as the circuit integrity of the network.
- Each light fitting is given a unique address for identification
- Control circuitry within each light fitting
- Charging rate
- Discharge current of the battery
- Battery status and output terminal voltage
- Battery capacity to ensure compliance to the rated standby time
- Checks internal resistance of the battery to manufacturer's specification
- Lamp lux levels and failure monitoring
- Input supply for overvoltage and undervoltage is monitored
- Circuit integrity of the networking cables

IMPERIA operates without a need for permanent connection to a PC or network. The controller is designed to make use of intuitive controls, allowing simple control and change to its attached DALI networks. Reports may be viewed on the screen, displayed directly. Alternatively, the reports can be uploaded to the IMPERIA sever.

IMPERIA is designed to control and monitor Class 1 DALI EXIT & Emergency Fittings ONLY. It does not have support for any other class of DALI component. The firmware of IMPERIA is upgradeable via USB or IMPERIA server

CABLE REQUIREMENTS

IMPERIA Master Panel is designed and tested to comply with the DALI Standard EN 62386 (VO and V1), for DALI emergency lighting components. The DALI cable connecting the luminaries in a circuit must be mains rated. 2 core cable and can be 1.0mm sq to 2.5mm sq, based on the circuit length required. The DALI cables must be of full mains rated voltage, since under certain fault conditions the DALI bus can become live at the mains voltage.

Without the use of a DALI 'repeater & PSU', the circuit length is limited to 300m (using 1.5mm sq cable), and this length is doubled with use of a 'repeater & PSU'. Maximum lengths of cables permitted to be connected to the DALI network depends on the size of cable used. Refer the table given for maximum permitted length for various size of cables.

Testing Mode

The smart emergency master panel can be programmed to initiate self test at predetermined time and date, or repeat the testing at pre-determined time duration. Typically it can be programmed for weekly, monthly and quarterly testing.

For large network of light fittings, selected zones / floors can be grouped together, and testing can be conducted only in this area at a pre-determined time.

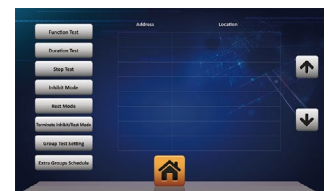

Alpha Numeric Addressing.

Each fitting can be addressed as below:
Name: There are 12 characters free for any Text Numeric or Special. Touch to bring up the Keypad for typing.

Location: There are 16 characters free for any Text Numeric or Special.



TECHNICAL DATA

IMPERIA MASTER PANEL	
RATED VOLTAGE AND FREQUENCY:	230V @ 50/60Hz, 6.0W
TEMPERATURE RANGE:	0°C to +50°C
WEIGHT	873g without power supplies and controls
DIMENSIONS	W x H x D: 213mmx150mmx35mm (including Surface mount housing Cutout Size: 198mm x 117mm)
PROTECTION RATING:	IP20 - Suitable for indoor use only
MEMORY CAPACITY	4 years of report Storage



DALI NETWORK WIRING OPTIONS

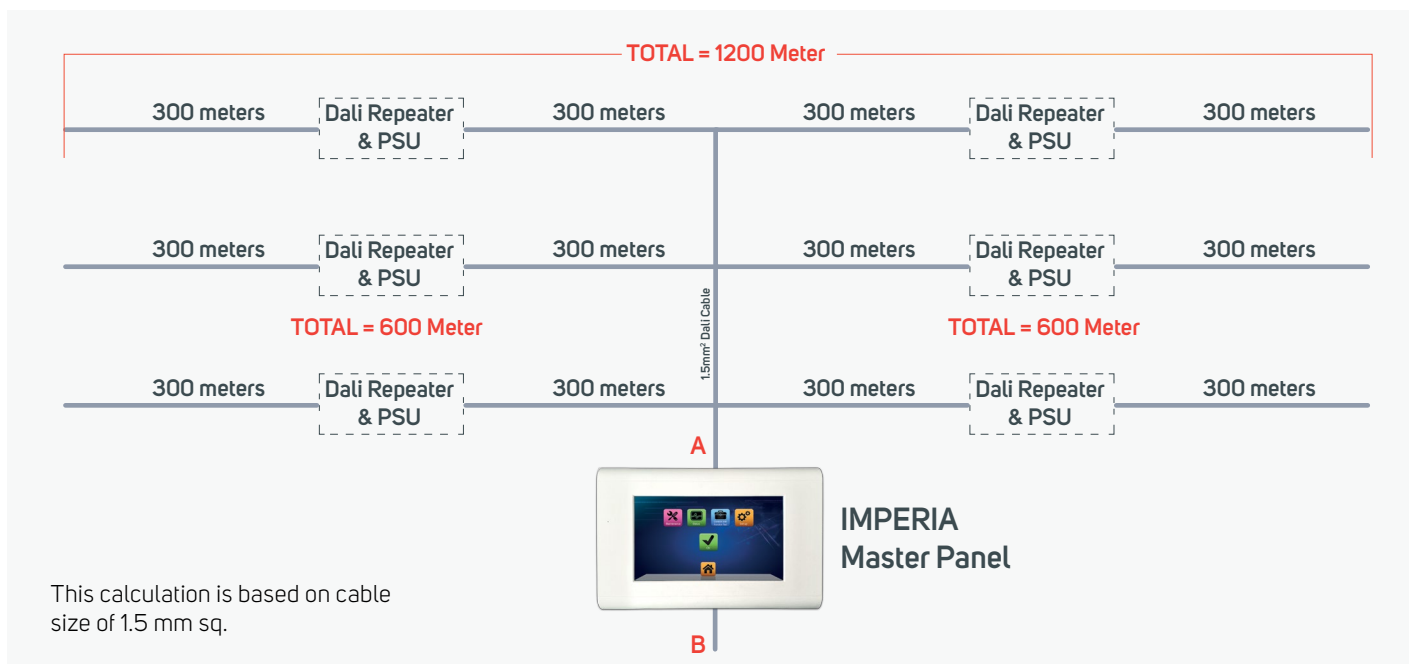

IMPERIA - DALI WIRING & NETWORKING

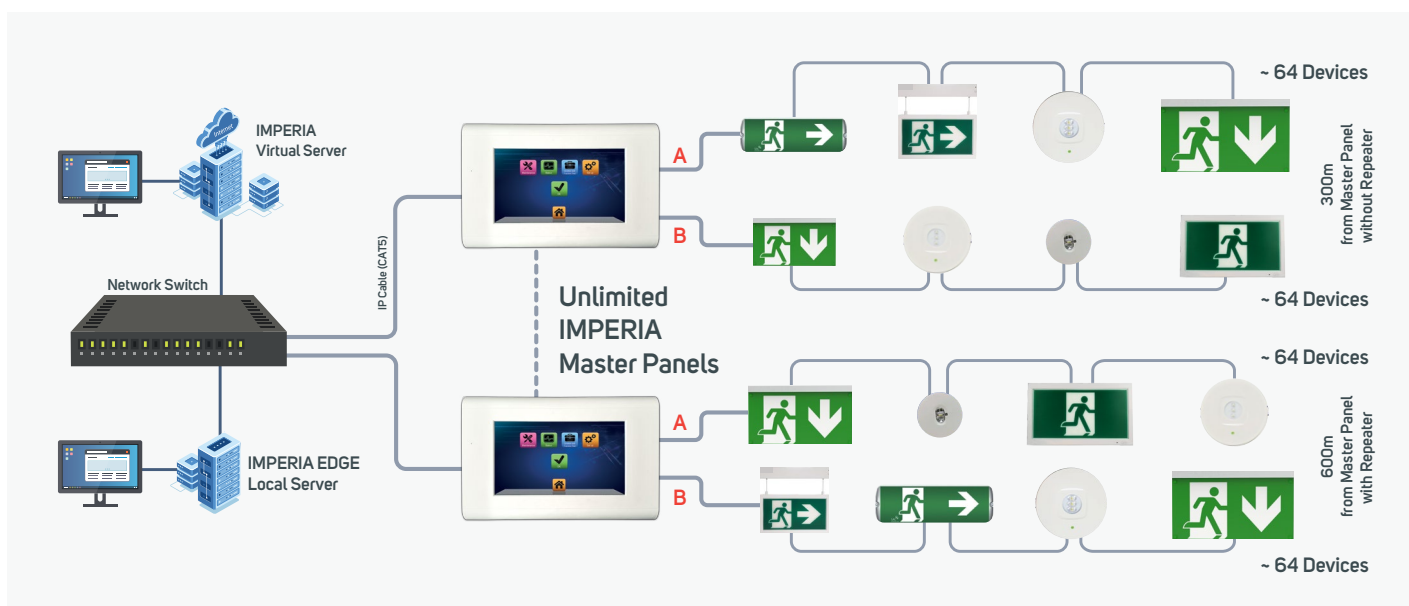

NOTES ON DALI WIRING

1. The maximum number of light fittings per DALI circuit (line) not to exceed 64.
2. DALI wiring topologies can be bus, star (hub & spike), tree or line wiring.
3. Ring & Mesh wiring cannot be used when using DALI protocol.
4. Each IMPERIA control unit can accommodate 2 DALI circuits, so a max of 128 light fittings per IMPERIA control unit.
5. The DALI circuit length is dependent on the size of cable used, as shown below:

- a) 1.0 mm sq cable will have a limit of 200m
- b) 1.5 mm sq cable will have a limit of 300m
- c) 2.5 mm sq cable will have a limit of 500m

6. Circuit length can be increased by using DALI repeater/ PSU (refer schematic drawings for clarification).

- a) The repeater & power supply only increases the circuit length and not the number of fittings (addresses) per circuit (Line).
- b) Use of a 'repeater/ PSU' unit doubles the DALI circuit length.
- c) Only one repeater/ PSU can be used per leg of the circuit. However additional repeater/ PSU can be used in another leg of the same circuit. (Ref schematic).

7. The DALI cables must be mains rated, capable of carrying the full mains voltage, as under certain fault conditions the DALI bus can become live at mains voltage.

8. Use of the IMPERIA EDGE server eliminates the need to have an internet connection for connecting to multiple IMPERIA controllers. Passive LAN networking connects all the controllers to a central computer.

DALI NETWORKED EMERGENCY LED LIGHT FITTINGS

MODEL: 8301-W3DH / 8301-N3DH
/ 8302-W3DH / 8302-N3DH



This range of fittings are standalone with build-in battery, and fully monitored on the DALI network, and meeting all the standards for a complete emergency lighting system.

FEATURUES

- Civil Defence approved
- Sleek LED lamps including flush and ceiling mount versions
- Suitable for anti-panic lighting with wide angle lens option
- Suitable for narrow and focused lighting with narrow lens
- Battery stand by time of 3 hrs for all fittings

Benefits

- Thermoplastic housing
- SMD LED 3030 1W, CCT 6500K
- Available for recessed mounting, and surface mounting with extra surface mounting kit
- Wide lens for open area, Narrow lens for corridor
- Can operate in non-maintained and switched maintained mode



8301-N3DH
Narrow lens for corridor



8301-W3DH
Wide lens for open area

LENS TYPE



DIMENSIONS & SURFACE MOUNTING KIT

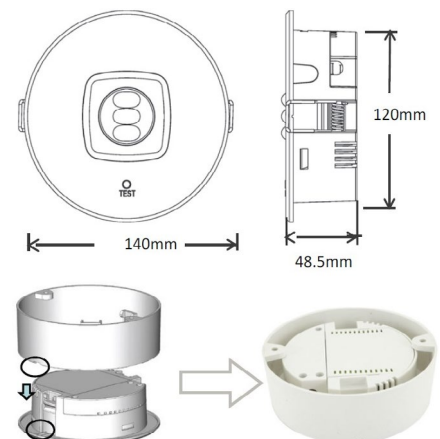

DALI NETWORKED EMERGENCY LED LIGHT FITTINGS

MODEL: 8203-3DH / 8204-3DH / 8202-3D80H

Benefits

- Polycarbonate trim plate and die casting heat sink
- Polycarbonate housing for LED driver and battery
- Special reflector design suitable for escape pathway
- Cut out hole : \varnothing 42-50mm
- Flux:180lm **8203-3DH** 180lm,**8204-3DH** 340lm
- Can operate in non-maintained and switched maintained mode



8203-3DH



8204-3DH



8202-3D80H

FEATRUES

- Civil Defence approved
- 24 hours charge
- 220-240VAC, 50/60Hz
- Suitable for narrow and focused lighting with narrow lens
- Battery stand by time of 3 hrs for all fittings

DIMENSIONS

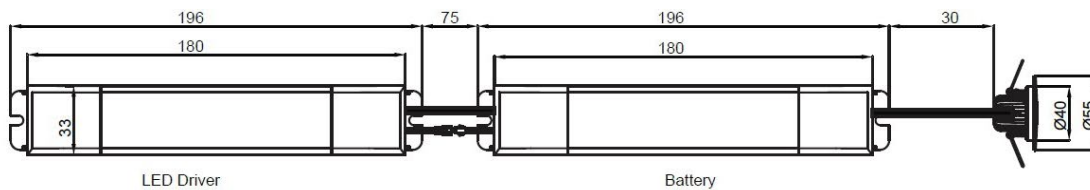

Cut out \varnothing 42- \varnothing 50

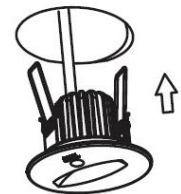

TECHNICAL SPECIFICATIONS

	8203-3DH	8204-3DH	8301-W3DH 8301-N3DH 8302-W3DH 8302-N3DH	8202-3DH 8202-3DH(80)
GENERAL	LED luminaire with Polycarbonate plate, with heat sink		LED luminaire with mounting option for recess or surface.	LED luminaire with polycarbonate plate
RATED POWER SUPPLY	220-240 VAC 50/60 Hz			
POWER CONSUMPTION	Max 5 W	Max 8 W	Max 4 W	Max 5 W
TESTING / MONITORING	DALI			
CHARGE TIME	24 HRS			
DISCHARGE TIME	3 HRS			
CHANGEOVER VOLTAGE	144-187 VAC			
OPERATION	MAINTAINED AND NON MAINTAINED			
BATTERY TYPE	NI-MH			
ROHS COMPLIANCE	Yes		---	Yes
NORMAL LUX	180 lm	340 lm	235 lm	150 lm
DEGREE OF PROTECTION	IP20			
INSULATION CLASS	Class II			
CERTIFICATION	CE, CB, SAA, C-tick, TÜV	CE, TÜV	CE, CB, TÜV	CE, TÜV
ADDITIONAL OPTION	--		Option for wide or narrow angle lens	Option for 80mm or 55mm flush cover



DALI Networked LED EXIT Lights

MODEL: 9110-3DH / 9111-3DH / 9105-3DH / 9112-3DH

FEATRUES

- Sleek, decorative and attractive design
- Wide range of size to suit user applications
- Extremely low power consumption
- Single and double face exit sign in the range
- All mounting type options available
- Viewing range of fittings suitable for all types of application
- Has all relevant 3rd party approvals .

This range covers DALI monitored LED exit signs are specifically designed for hotels and large shopping mall, where in addition to the artistic & sleek design, it has to meet all requirements for 3rd party approval / Civil Defence approval. As viewing distance for exit signs are directly calculated on size of luminaires, we have the complete size range of fittings, suitable for high installations and also for long corridors.

With DALI open protocol being used for monitoring, maintained and non-maintained fittings are on the same monitoring circuit, and upto 64 fittings can be connected on a single circuit, and with networking of the smart control unit, unlimited fittings are monitored and status documented on a central control PC.

Benefits

- Flexibility in design and applications
- Wall and ceiling mounting
- Suspension mount available with Max.1 Meter suspension wires
- Quick connection and easy installation



9105-3DH



9112-3DH



9111-3DH



9110-3DH

DALI Networked LED EXIT Lights

MODEL: 9420-3DL / 9430-3DL / 9440-3DL / 9450-3DL



Benefits

- Various viewing distances for different applications (20M,30M,40M,50M)
- Wall, ceiling & surface mounting
- DALI interface with NFC function
- Smart Wireless system available
- Replaceable LiFePO4 Lithium Battery provides improved energy consumption

Pictogram Insert



Option-Left



Option-Right



Option-Down

DIMENSIONS

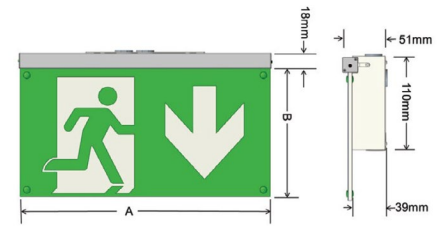

Item	A(mm)	B(mm)
VIEW/20M	196	100
VIEW/30M	294	150
VIEW/40M	392	200
VIEW/50M	490	250

*Default Colour:PANTONE 348C

(Style and Colour can be designed as request)

TECHNICAL SPECIFICATIONS

	9110-3DH 9111-3DH	9112-3DH	9105-3DH	9420-3DL 9430-3DL 9440-3DL 9450-3DL 9420-3DL(N) 9440-3DL(N) 9450-3DL(N)
GENERAL	Compact and decorative LED design			Decorative & sleek, with normal to long viewing distance
RATED POWER SUPPLY	220-240VAC 50/60 Hz			
POWER CONSUMPTION	6.4 W	4.7 W	3.5 W	6 W
TESTING / MONITORING	DALI			
CHARGE TIME	24 HRS			
DISCHARGE TIME	3 HRS			
CHANGEOVER VOLTAGE	144-187 VAC			
OPERATION	MAINTAINED AND NON MAINTAINED		MAINTAINED	
BATTERY TYPE	NICKEL METAL HYDRIDE			LITHIUM IRON PHOSPHATE
NORMAL LUX	30m	24m	24	Various models with 20, 30, 40 & 50m
DEGREE OF PROTECTION	IP20		IP40	IP20
INSULATION CLASS	Class II			Class I
CERTIFICATION	CE, CB, TÜV	CE, CB, TÜV	CE, CB, TÜV	CE, CB, TÜV
ADDITIONAL OPTION	Wall & ceiling mount	Wall surface and flush mount	Wall & ceiling mount, surface / recess kit	Wall mounting and ceiling surface mount



Self Contained LED Emergency Lights

MODEL: 8202 / 8203-AH / 8203-MH/ 8204-3AH

Self contained LED emergency lights with built-in battery, control and switching units. This type of emergency lights have option to work on 'maintained' or 'non-maintained' mode. Some models also come with the 'Switched maintained mode' of operation. All models are robust, cost effective and having 3rd party approvals.

FEATRUES

- Option for manual testing or auto test.
- Have 3rd party approval for stand alone operation
- Robust and cost effective
- Low power consumption
- 3 hrs and 1 hr battery stand-by time option
- Recharge time for fully discharged battery not exceeding 24 hrs
- Flush ceiling, wall & ceiling surface mount options
- Range suitable for anti-panic with wide angle lens and narrow angle lens for corridors

Benefits

- Polycarbonate trim plate and die casting aluminum heat sink
- Polycarbonate housing for LED driver and battery
- Special reflector design suitable for escape pathway



8203 Range



8204 Range



8202 Range

DIMENSIONS (8202 Range)

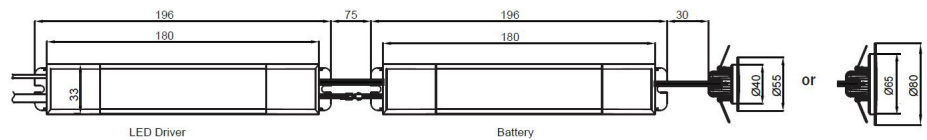

TECHNICAL SPECIFICATIONS

	8202-3AH 8202-3AH (80) 8202-1AH 8202-1AH(80)	8203-3AH 8203-1AH	8203-3MH 8203-1MH	8204-3AH 8204-1AH	8204-3MH
GENERAL	Stand alone, ceiling recess mounted LED light with polycarbonate trip plate, battery and heat sink				
RATED POWER SUPPLY	220-240 VAC 50/60 Hz				
POWER CONSUMPTION	5 W			4W	
TESTING / MONITORING	SELF CONTAINED AUTO TEST IN COMPLIANCE TO IEC62034		MANUAL TEST	SELF CONTAINED AUTO TEST IN COMPLIANCE TO IEC62034	MANUAL TEST
CHARGE TIME	24 HRS				
DISCHARGE TIME	OPTION FOR 1 HR & 3 HRS BATTERY CAPACITY			1HR AND 3HRS OPTION	3 HRS
CHANGEOVER VOLTAGE	144-187 VAC				
OPERATION	MAINTAINED AND NON MAINTAINED			MAINTAINED	
BATTERY TYPE	NICKEL METAL HYDRIDE				
NORMAL LUX	150 lm		180 lm		
DEGREE OF PROTECTION	IP20				
INSULATION CLASS	Class II				
CERTIFICATION	CE, TÜV	CE, CB, TÜV	CE, CB, TÜV	CE, CB, TÜV	CE, CB, TÜV

Self Contained LED Emergency Lights

MODEL: 8301-3MH (W / N) / 8301-3AH (W / N)
/ 8302-3MH (W / N) / 8302-3MH (W / N)



8301-SERIES
Narrow lens for corridor



8302-SERIES
Wide lens for open area

FEATRUES

- Option for manual testing or auto test.
- Have 3rd party approval for stand alone operation
- Robust and cost effective
- Low power consumption
- 3 hrs and 1 hr battery stand-by time option
- Recharge time for fully discharged battery not exceeding 24 hrs
- Flush ceiling, wall & ceiling surface mount options
- Range suitable for anti-panic with wide angle lens and narrow angle lens for corridors

LENS TYPE



DIMENSIONS & SURFACE MOUNTING KIT

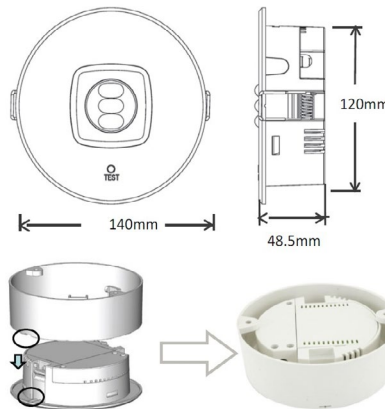

TECHNICAL SPECIFICATIONS

	8301-3MH (W / N) 8301-1MH (W / N)	8301-3AH (W / N) 8301-1AH (W / N)	8302-3MH (W / N) 8302-1MH (W / N)	8302-3MH (W / N) 8302-1AH (W / N)
GENERAL	Standalone LED emergency light, with multiple options for operating mode, lens type, battery and testing method .			
RATED POWER SUPPLY	220-240 VAC 50/60 Hz			
POWER CONSUMPTION	4 W			
TESTING / MONITORING	MANUAL TEST	AUTO TEST	MANUAL TEST	AUTO TEST
CHARGE TIME	24 HRS			
DISCHARGE TIME	OPTION FOR SELECTING BATTERY CAPACITY WITH 1 HR OR 3 HRS OF DISCHARGE TIME.			
CHANGEOVER VOLTAGE	144-187 VAC			
OPERATION	MAINTAINED AND NON MAINTAINED		NON MAINTAINED	
BATTERY TYPE	NICKEL METAL HYDRIDE			
MOUNTING	Recess mounting and ceiling surface mounting option.			
DEGREE OF PROTECTION	IP20			
INSULATION CLASS	Class II			
CERTIFICATION	CE, CB, TÜV			
ADDITIONAL OPTION	Wide lens (W) for open area anti panic lighting and for exit routes narrow lens (N) to be selected.			



94XX SERIES

Self Contained LED EXIT Lights

MODEL: 9105-1MH /9108-1MH /9109-3MH
/9110-1MH /9111-1MH /9112-1MH /9420-1AL

Standalone, self contained LED exit lights with build-in battery and all control, switching and testing facility with international 3rd party approvals. A wide range of LED exit light models for all types of installations, including wall, ceiling, & semi flush types. Various sizes of exit signs can be selected for long range and high ceiling installations.

FEATRUES

- All LED fittings are consuming extremely low power, and hence very cost effective.
- Sleek design blends with even the most modern architecture.
- Fully standalone with built-in battery
- Testing options of auto test and manual test
- Various battery models available with each fittings
- Battery capacity can be appropriately selected to suit the discharge time required.

Benefits

- Flexibility in design and applications
- Wall and ceiling mounting
- Suspension mount available with Max.1 Meter suspension wires
- Quick connection and easy installation
- Various viewing distances for different applications (20M,30M,40M,50M)
- Wall, ceiling & surface mounting
- Replaceable LiFePO4 Lithium Battery provides improved energy consumptio



9105



9108



9109



9110



9111



9112

Self Contained LED EXIT Lights

TECHNICAL SPECIFICATIONS

	9105-1MH 9105-1AH 9105-3MH 9105-3AH	9108-1MH 9108-1AH 9108-3MH 9108-3AH	9109-3MH 9109-3AH 9109-1MH 9109-1AH	9110-1MH 9110-1AH 9110-1MC 9110-1AC	9110-3MH 9110-3AH 9110-3MC 9110-3AC
GENERAL	LED Exit lights, with low power consumption. Standalone self-contained exit light with build-in battery and control / monitoring setup.				
RATED POWER SUPPLY	220-240VAC 50/60 Hz				
POWER CONSUMPTION	4W	5.6W	3.5 W	3.5	
TESTING / MONITORING	AUTO TEST AND MANUAL TEST MODELS OPTIONAL				
SPECIAL FEATURES	---	SINGLE AND DOUBLE FACE UNIVERSAL.	HANGING ESCAPE SIGN	SINGLE AND DOUBLE FACE UNIVERSAL.	
CHARGE TIME	24 HRS				
DISCHARGE TIME	OPTION TO SELECT BATTERY CAPACITY WITH 1 HR AND 3 HRS DISCHARGE TIME.				
CHANGEOVER VOLTAGE	144-187 VAC				
OPERATION	MAINTAINED	MAINTAINED & NON-MAINTAINED			
BATTERY TYPE	NICKEL METAL HYDRIDE			OPTION FOR NI-CD OR NI-MH BATTERY	
VIEWING DISTANCE	24m	24M	24M	30M	
DEGREE OF PROTECTION	IP40	IP20	IP40	IP20	IP20
INSULATION CLASS	Class II				
CERTIFICATION	CE, CB, TÜV				
ADDITIONAL OPTION	Wall mounting & ceiling mount with recessed mount kit	Option for wall or ceiling mount.	Wall & ceiling mount, surface / recess kit		

TECHNICAL SPECIFICATIONS

	9111-1MH 9111-1AH	9111-3MH 9111-3AH	9112-1MH 9112-1AH 9112-3MH 9112-2AH	9420-1AL 9420-3AL 9430-1AL 9430-3AL	9440-1AL 9440-3AL 9450-1AL 9450-3AL
GENERAL	Hanging type, LED self-contained exit lights. Sleek & decorative design.		Wall mounted standalone LED exit light	Standard to extra-large size self-contained LED exit lights to suit special long range & high installations	
RATED POWER SUPPLY	220-240VAC 50/60 Hz				
POWER CONSUMPTION	6.4W	6.4W	4.7W	6W	
TESTING / MONITORING	AUTO TEST AND MANUAL TEST MODELS OPTIONAL				
SPECIAL FEATURES	REPLACEABLE PICTOGRAM			VIEWING DISTANCE VARIES FROM 20M TO 50M FOR VARIOUS MODELS	
CHARGE TIME	24 HRS				
DISCHARGE TIME	OPTION TO SELECT BATTERY CAPACITY WITH 1 HR AND 3 HRS DISCHARGE TIME.				
CHANGEOVER VOLTAGE	144-187 VAC				
OPERATION	MAINTAINED & NON-MAINTAINED			MAINTAINED	
BATTERY TYPE	NI-MH BATTERY		NICKEL METAL HYDRIDE	LITHIUM IRON PHOSPHATE	
VIEWING DISTANCE	30m	30m	24M	20m, 30m, 40m & 50m	
DEGREE OF PROTECTION	IP30	IP20	IP40	IP20	IP40
INSULATION CLASS	Class II				
CERTIFICATION	CE, CB, TÜV				
ADDITIONAL OPTION	Wall & ceiling mounting.	DO	Wall surface mount & wall flush mount	Wall mounting & ceiling surface mounting	

PARTS LIST

Emergency LED Light

PRODUCT CODE	DESCRIPTION
8202 SERIES MICO MINI LED EMERGENCY DOWN LIGHT	
8202-3AH	Auto Test 8202 Series Mico Mini LED Emergency Down Light with Ni-MH Battery & 3hr Emergency Duration
8202-3DH	DALI- 8202 Series Mico Mini LED Emergency Down Light with Ni-MH Battery & 3hr Emergency Duration
8202-3AH(80)	Auto Test 8202 Series Mico Mini LED Emergency Down Light with Ni-MH Battery & 3hr Emergency Duration (80mm Round Cover)
8202-3DH(80)	DALI- 8202 Series Mico Mini LED Emergency Down Light with Ni-MH Battery & 3hr Emergency Duration (80mm Round Cover)
8202-1AH	Auto Test 8202 Series Mico Mini LED Emergency Down Light with Ni-MH Battery & 1hr Emergency Duration
8202-1DH	DALI- 8202 Series Mico Mini LED Emergency Down Light with Ni-MH Battery & 1hr Emergency Duration
8202-1AH(80)	Auto Test 8202 Series Mico Mini LED Emergency Down Light with Ni-MH Battery & 1hr Emergency Duration (80mm Round Cover)
8202-1DH(80)	DALI- 8202 Series Mico Mini LED Emergency Down Light with Ni-MH Battery & 1hr Emergency Duration (80mm Round Cover)
8203 SERIES MICO MINI LED EMERGENCY DOWN LIGHT	
8203-1AH	Auto Test 8203 Series Mico Mini LED Emergency Down Light with Ni-MH Battery & 1hr Emergency Duration
8203-1MH	Manual Test 8203 Series Mico Mini LED Emergency Down Light with Ni-MH Battery & 1hr Emergency Duration
8203-1DH	DALI- 8203 Series Mico Mini LED Emergency Down Light with Ni-MH Battery & 1hr Emergency Duration
8203-3AH	Auto Test 8203 Series Mico Mini LED Emergency Down Light with Ni-MH Battery & 3hr Emergency Duration
8203-3MH	Manual Test 8203 Series Mico Mini LED Emergency Down Light with Ni-MH Battery & 3hr Emergency Duration
8203-3DH	DALI- 8203 Series Mico Mini LED Emergency Down Light with Ni-MH Battery & 3hr Emergency Duration
8204 SERIES MICO MINI LED EMERGENCY DOWN LIGHT	
8204-1AH	Manual Test 8204 Series Mico Mini LED Emergency Down Light with Ni-MH Battery & 1hr Emergency Duration
8204-1DH	DALI- 8204 Series Mico Mini LED Emergency Down Light with Ni-MH Battery & 1hr Emergency Duration
8204-3AH	Manual Test- 8204 Series Mico Mini LED Emergency Down Light with Ni-MH Battery & 3hr Emergency Duration
8204-3MH	Manual Test 8204 Series Mico Mini LED Emergency Down Light with Ni-MH Battery & 3hr Emergency Duration
8204-3DH	DALI- 8204 Series Mico Mini LED Emergency Down Light with Ni-MH Battery & 3hr Emergency Duration
8204-1MH	Manual Test 8204 Series Mico Mini LED Emergency Down Light with Ni-MH Battery & 1hr Emergency Duration
8301 SEREIS EMERGENCY LUMINAIRE DOWN LIGHT	
8301-3MH(W)	Manual Test-8301 Sereis Wide Lens Emergency Luminaire Down Light with Ni-MH Battery & 3hr Emergency Duration
8301-3MH(N)	Manual Test-8301 Sereis Narrow Lens Emergency Luminaire Down Light with Ni-MH Battery & 3hr Emergency Duration
8301-3AH(W)	Auto Test-8301 Sereis Wide Lens Emergency Luminaire Down Light with Ni-MH Battery & 3hr Emergency Duration
8301-3AH(N)	Auto Test-8301 Sereis Narrow Lens Emergency Luminaire Down Light with Ni-MH Battery & 3hr Emergency Duration
8301-3DH(W)	DALI-8301 Sereis Wide Lens Emergency Luminaire Down Light with Ni-MH Battery & 3hr Emergency Duration
8301-3DH(N)	DALI-8301 Sereis Narrow Lens Emergency Luminaire Down Light with Ni-MH Battery & 3hr Emergency Duration

8301-1MH(W)	Manual Test-8301 Sereis Wide Lens Emergency Luminaire Down Light with Ni-MH Battery & 1hr Emergency Duration
8301-1MH(N)	Manual Test-8301 Sereis Narrow Lens Emergency Luminaire Down Light with Ni-MH Battery & 1hr Emergency Duration
8301-1AH(W)	Auto Test-8301 Sereis Wide Lens Emergency Luminaire Down Light with Ni-MH Battery & 1hr Emergency Duration
8301-1AH(N)	Auto Test-8301 Sereis Narrow Lens Emergency Luminaire Down Light with Ni-MH Battery & 1hr Emergency Duration
8301-1DH(W)	DALI-8301 Sereis Wide Lens Emergency Luminaire Down Light with Ni-MH Battery & 1hr Emergency Duration
8301-1DH(N)	DALI-8301 Sereis Narrow Lens Emergency Luminaire Down Light with Ni-MH Battery & 1hr Emergency Duration
8302 SEREIS EMERGENCY LUMINAIRE DOWN LIGHT	
8302-1MH(W)	Manual Test-8302 Sereis Wide Lens Emergency Luminaire Down Light with Ni-MH Battery & 1hr Emergency Duration
8302-1MH(N)	Manual Test-8302 Sereis Narrow Lens Emergency Luminaire Down Light with Ni-MH Battery & 1hr Emergency Duration
8302-1AH(W)	Auto Test-8302 Sereis Wide Lens Emergency Luminaire Down Light with Ni-MH Battery & 1hr Emergency Duration
8302-1AH(N)	Auto Test-8302 Sereis Narrow Lens Emergency Luminaire Down Light with Ni-MH Battery & 1hr Emergency Duration
8302-1DH(W)	DALI-8302 Sereis Wide Lens Emergency Luminaire Down Light with Ni-MH Battery & 1hr Emergency Duration
8302-1DH(N)	DALI-8302 Sereis Narrow Lens Emergency Luminaire Down Light with Ni-MH Battery & 1hr Emergency Duration
8302-3MH(W)	Manual Test-8302 Sereis Wide Lens Emergency Luminaire Down Light with Ni-MH Battery & 3hr Emergency Duration
8302-3MH(N)	Manual Test-8302 Sereis Narrow Lens Emergency Luminaire Down Light with Ni-MH Battery & 3hr Emergency Duration
8302-3AH(W)	Auto Test-8302 Sereis Wide Lens Emergency Luminaire Down Light with Ni-MH Battery & 3hr Emergency Duration
8302-3AH(N)	Auto Test-8302 Sereis Narrow Lens Emergency Luminaire Down Light with Ni-MH Battery & 3hr Emergency Duration
8302-3DH(W)	DALI-8302 Sereis Wide Lens Emergency Luminaire Down Light with Ni-MH Battery & 3hr Emergency Duration
8302-3DH(N)	DALI-8302 Sereis Narrow Lens Emergency Luminaire Down Light with Ni-MH Battery & 3hr Emergency Duration

UNDERSTANDING PART NUMBERS

SERIES		XYZ			(W/N/H/80)	
8	9	X	Y	Z	ONLY FOR SPECIAL OPTIONS	
LED EMERGENCY LIGHT	LED Exit	Battery Discharge Duration	Type of test	Battery Type	Application	
		1 For 1 Hr	M	L	W	Wide lens for open area
		3 For 3 Hrs	A		N	Narrow lens for corridor
			D	H	H	A product with DALI function, a handset device allowed to manage the address and group of fittings
					80	Dia. 80mm round cover

TECHNOLOGY MANAGEMENT



DYNAMICPRO



Unit 157 - 99 Scurfield Boulevard,
Winnipeg, MB, R3Y 1Y1, CANADA.
Tel.: +1 (204) 306 5173
Email: info@dynamicpro.ca
Website: www.dynamicpro.ca



ATEIS Middle East FZCO.
For Middle East & India Inquiries
LIU No. 11, Dubai Silicon Oasis, P.O. Box 293640
Dubai, United Arab Emirates
Tel: +971 (4) 3262730 - Fax: +971 (4) 3262731
info@ateis.ae